



Included:

- 2 Special Clamps consisting of 2 screws (#1), 1 knob (#5), the clamp body (#3), and the clamp cap (#2).
- 2 “L” shaped Healthy Handle bars (#4)
- 1 Hex Key/Allen wrench (#6)

To Install: Watch video at www.healthyhandles.com

- 1) Remove the 2 screws from one of the clamps using the hex key provided. This might be harder than you expect due to a safety feature of the screw itself, which prevents loosening due to the vibration of your stroller.
- 2) Place the small side of the clamp on the inside of the left parallel bar of your stroller. **IMPORTANT:** Make sure the NOTCH in the bottom of the clamp matches up on both sides. **DO NOT** install the small side of the clamp upside down. (See Figure 1 “Notch.”)
- 3) Place the large side of the clamp on the opposite side of the left parallel bar, making sure the knob is facing up. Hold the two sides together.
- 4) Place the screws through the small end of the clamp into the big end. Tighten to a semi-snug fit.
- 5) Place the long end of one of the “L” shaped bars into the open end of the clamp. Be sure to pass the “Rivet in Handlebar” through the notch in the clamp (Fig. 1 & Fig. 3). Push the bar all the way through the clamp.
- 6) Align the Healthy Handle bar to the exact angle of the stroller frame. Adjust clamp if necessary to achieve proper alignment.
- 7) Tighten the clamp screws all the way to keep them in place for good.
- 8) Repeat process for the right side.

Note: When you adjust your handles to the position you desire, it is not necessary to tighten the knob too tight. Tightening it too tight will make it difficult to loosen.

Figure 1

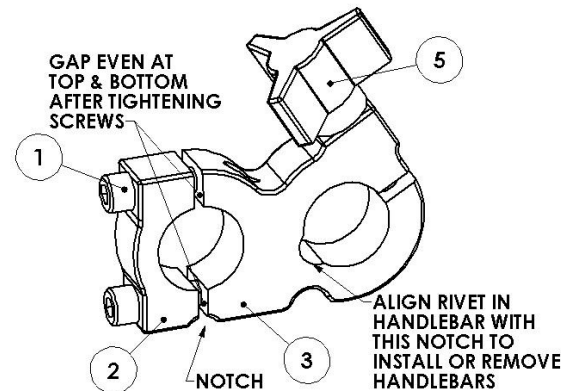

Figure 2

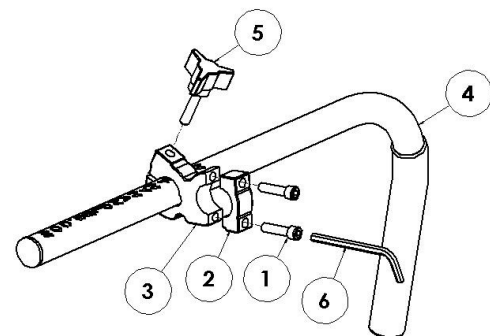
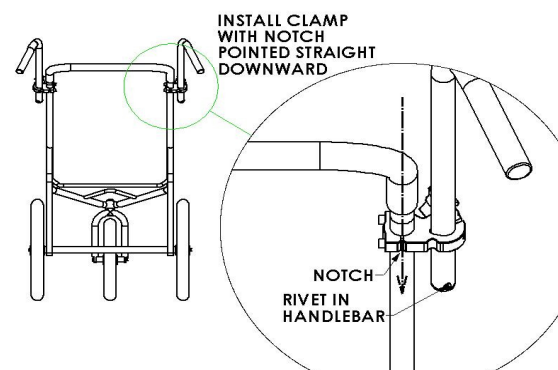

Figure 3



WARNINGS:

- Healthy Handles are completely safe when installed properly. If you have any questions regarding your installation, call 1-800-805-6897.
- **DO NOT** hang anything or stack anything on the extended handlebars, as this could cause your stroller to tip backward.
- **DO NOT** install Healthy Handles on any stroller bar that does not fit perfectly inside our special clamp.